

SERVICES

COAT CHECK

A coat check is available during regular Museum hours for coats, backpacks, luggage, and large strollers.

LOST AND FOUND

Lost and Found is located at the Reception Desk.

WI-FI

Wi-Fi is available in the Cloud Bistro, exhibition areas, and in the seating area outside the Museum.

VISITOR GUIDELINES

Please observe the following guidelines for the comfort of our guests and the preservation of our precious artifacts:

Historic artifacts are priceless and easily damaged. Please do not touch them.

Personal non-flash photography is permitted throughout the Museum's exhibition areas. Use of flash, tripods, or other equipment is prohibited.

No backpacks or luggage allowed in the exhibition areas.

Ticket is valid only for the date indicated. No refunds or exchanges.

Food and drink are not permitted in the exhibition areas.

The Museum is not responsible for lost or stolen articles.

Children ages 12 and under must be accompanied by an adult.

STORE

Looking for a unique gift, computer-related read, Silicon Valley souvenir, or sundries to make your visit more comfortable? Our 1,500-square-foot store includes tech-related gifts and gadgets. Museum admission not required. Members receive a 10% discount on purchases. Hours: Tue–Thurs, Sat & Sun, 10 a.m.–5 p.m. / Fri, 10 a.m.–8 p.m.

CLOUD BISTRO

The Cloud Bistro features freshly brewed coffee, local wines, and tasty sandwiches and salads. Dine during your Museum visit or stop in for coffee. Museum admission not required. Members receive a 10% discount. Hours: Wed, Thurs, 8 a.m.–5 p.m. / Fri, 8 a.m.–7 p.m. / Sat & Sun, 10 a.m.–5 p.m.

ABOUT US

The Computer History Museum in Mountain View, California, is a nonprofit organization with a four-decade history as the world's leading institution exploring the history of computing and its ongoing impact on society. The Museum is dedicated to the preservation and celebration of computer history and is home to the largest international collection of computing artifacts in the world, encompassing computer hardware, software, documentation, ephemera, photographs, oral histories, and moving images.

MUSEUM HOURS*

Wed, Thurs, Sat & Sun, 10 a.m.–5 p.m. /
Fri, 10 a.m.–8 p.m.

*See our store and bistro for special and extended hours

MEMBERSHIP

Become a part of our community and take advantage of member benefits. A Museum membership is a fun way for technology fans to get involved with CHM. See the Reception Desk for more information or visit us online at computerhistory.org/membership.

EDUCATION

Exhibition tours, artifact demonstrations, and hands-on workshops are available for learners of all ages. Visit us online at computerhistory.org/education.

SUPPORT

Generous contributions from individuals like you support our work in collections, exhibition development, and educational programming. Help us tell the fascinating stories of the Information Age by giving a gift today. Visit us at computerhistory.org/contribute.

CONTACT US

1401 N. Shoreline Blvd.
Mountain View, CA 94043
650.810.1010

computerhistory.org/visit

VISITOR MAP

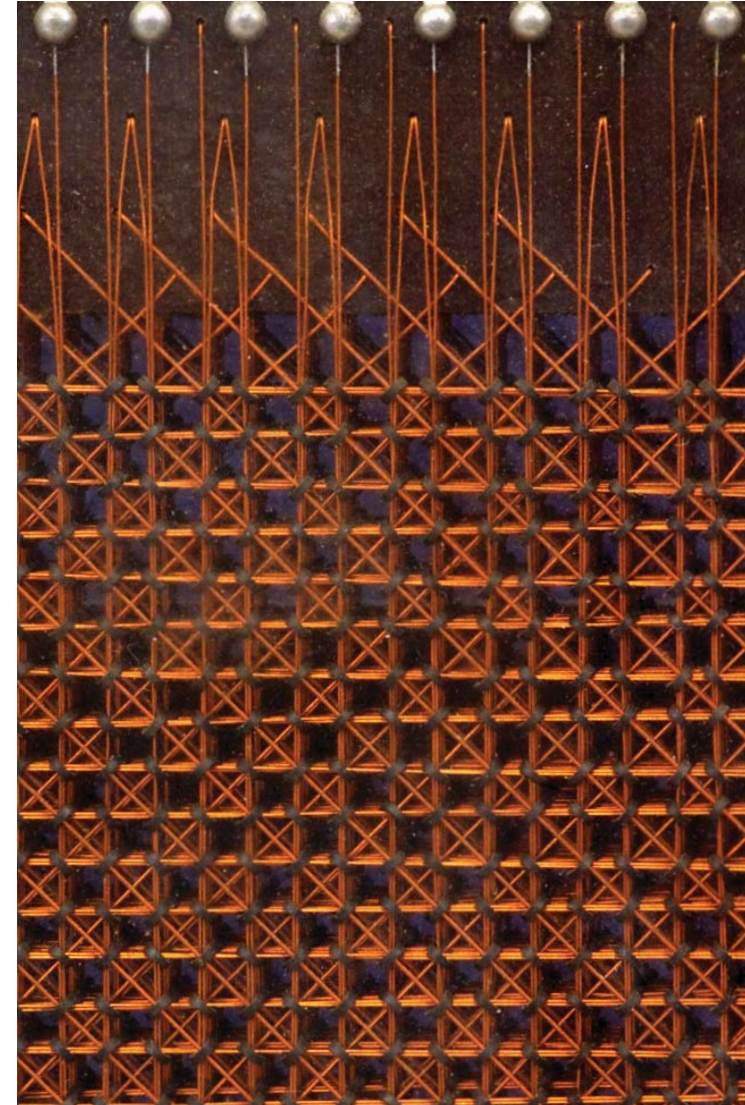

01.2017 / "LITTLE CHARACTER" PROTOTYPE / 1958 / CONTROL DATA CORPORATION / ©MARK RICHARDS

EXHIBITS

Revolution: The First 2000 Years of Computing

This exhibition celebrates the spectacular history of computing, from mysterious ancient devices to technologies of the future. Journey through 19 galleries, each dedicated to a different aspect of computing. Discover, in our multimedia displays, the backstories, development drama, and astonishing breakthroughs of the gadgets, gurus, and companies you love or love to hate.

Thinking Big: Ada, Countess of Lovelace

Be inspired by the remarkable life of English mathematician and visionary Ada Lovelace (1815–1852). Drawing on the Lovelace papers held at the University of Oxford's Bodleian Libraries, this exhibit features reproductions from the Bodleian's exceptional collection as well as paintings and photographs from Lovelace's life that highlight her mathematical prowess and forward-thinking imagination.

Make Software: Change the World!

Fly through *World of Warcraft's* fantastic world of Azeroth, learn Photoshop from the pros, and speed-text your way to victory in our newest, interactive exhibition. This uniquely designed space follows the stories of seven transformative software applications—Photoshop, MP3, MRI, Car Crash, Wikipedia, Texting, and *World of Warcraft*. A multimedia software lab anchors the exhibition and encourages visitors to learn programming basics through a series of interactive activities.

The Demo Labs

Experience classic computing in our PDP-1 and IBM 1401 Demos Labs. Learn how the DEC PDP-1 minicomputer captivated an early generation of hackers with its real-time capability, advanced graphics, and interstellar game *Spacewar!* Discover the sights and sounds of a 1960s business center featuring one of the most popular mainframe computers of all time, the IBM 1401.

Where To? A History of Autonomous Vehicles

Taking land, air, and sea by storm! Discover the decades-long challenge of bringing self-driving cars to the general public. Self-driving cars have remained perpetually two decades away since the 1930s, while over the past century, autonomous and semi-autonomous vehicles have conquered the air, sea and roamed the edges of our solar system.



REVOLUTION



THINKING BIG

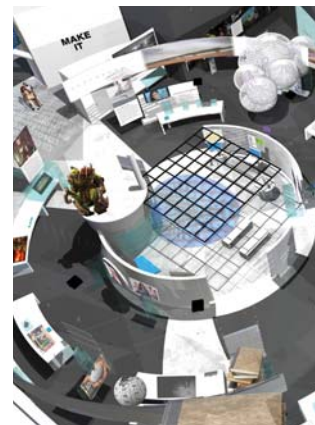

MAKE SOFTWARE



THE DEMO LABS



WHERE TO?

MUSEUM MAP

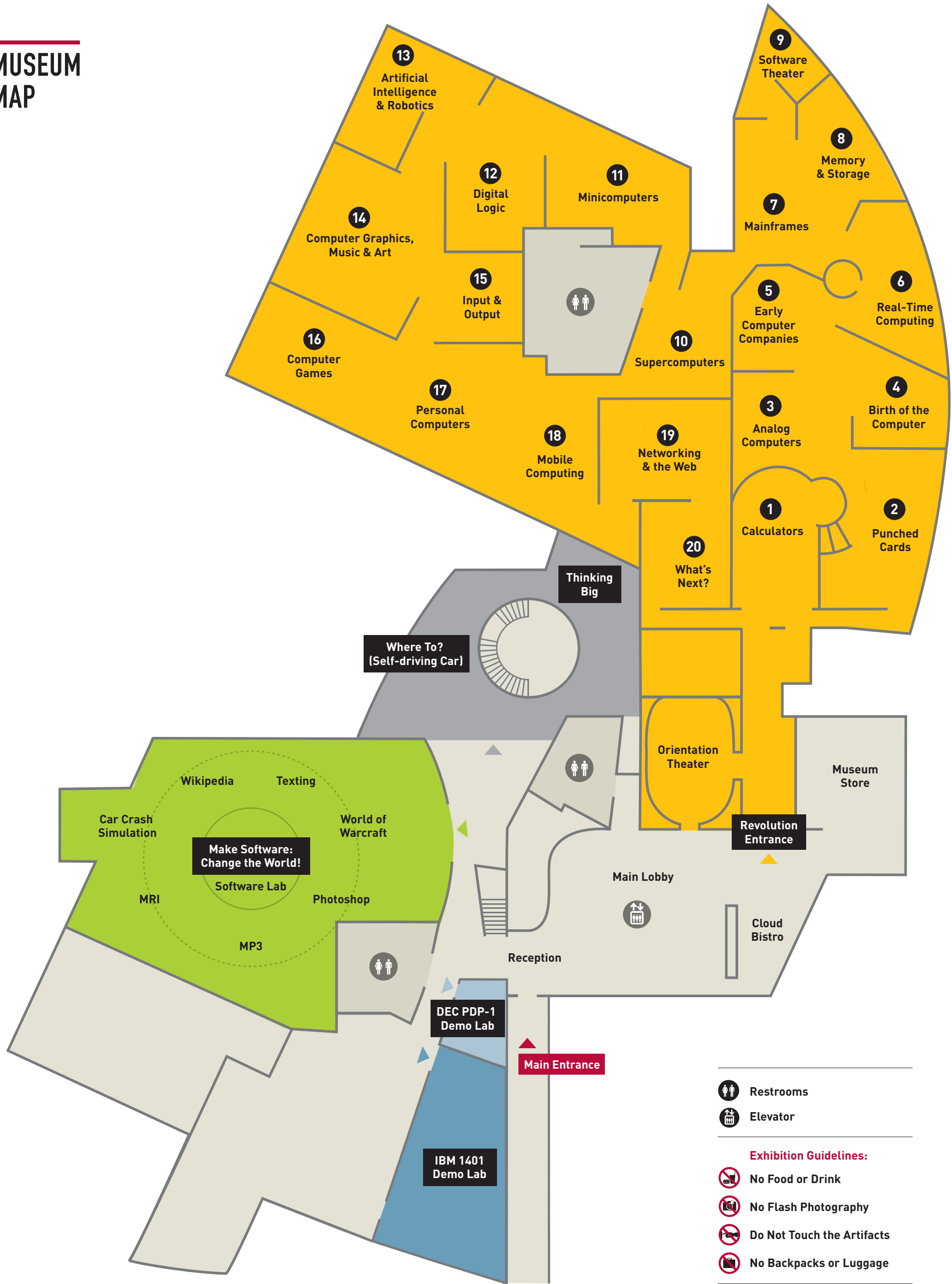

EXHIBITS



REVOLUTION

THINKING BIG

MAKE SOFTWARE

THE DEMO LABS

WHERE TO?